

B-SM-LA-01 CHIP ACTUATOR

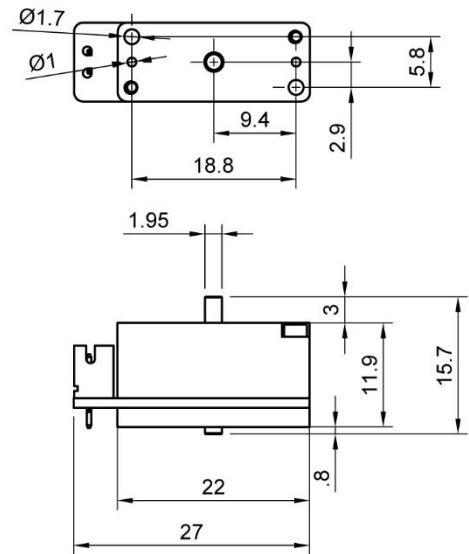

General Information

Type	Monostable linear actuator
Functionality	Push or pull (normally open / normally closed), proportional control
Housing	Anodized aluminum
Push/Pull Pin	Steel 1.4301
Dimensions (WxLxH)	9 mm x 22 mm x 15.7 mm (without electrical connections)
Weight	5 g
Electric connector	JST B2B-PH-K-S(LF)(SN)
Mounting interface	Flange mount M2 screws
Cycle life time	> 25 000 cycles

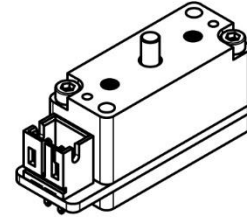
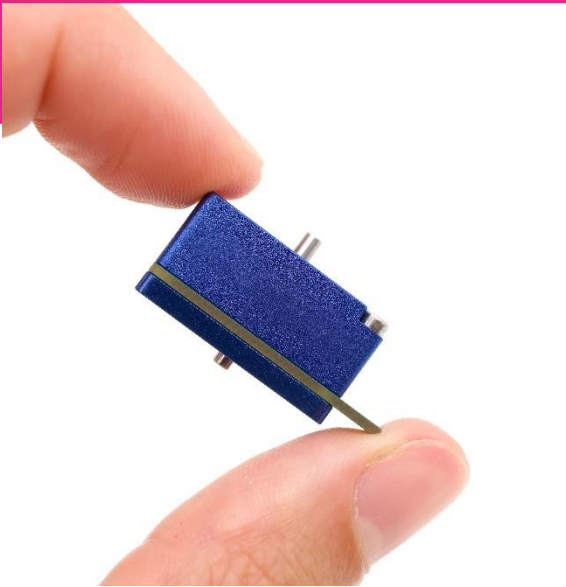
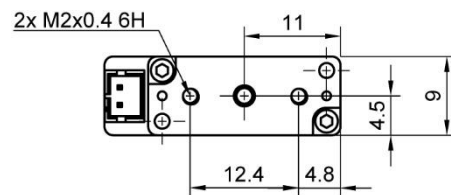
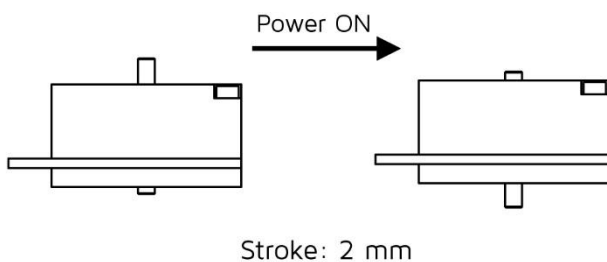

Dimensions in millimeters



BMT Fluid Control Solutions GmbH
 Max-Planck-Straße 16 – D-61381 Friedrichsdorf
 Tel.: +49 6101 95400-30 – Fax: +49 6101 95400-39

info@pumpen-ventile.de – www.pumpen-ventile.de

Technische Änderungen Vorbehalten

2023-08



Performance Data

Stroke	2,0 mm \pm 0,1 mm
Normally closed force (passive)*	0,8 N at 1 mm stroke
Push/pull force (when powered)	max 3,5 N
Operating temperature	10°C to 50° C
Storage temperature	-20°C to 90°C
Switching time (on)	1 s with 1,9 A (at ambient temperature of 20°C)
Switching time (off)	6 s (at ambient temperature of 20°C)
Maximum switching frequency	0,15 Hz

* For higher NC forces, contact us

Electrical Specifications

Electronic control	Constant current
Electrical connection	Soldering pads or JST B2B-PH-K-S(LF)(SN)
Actuator resistance*	0,5 Ω \pm 10%

* Data at 20 °C

Control using current profile

Peak electrical current*	1,9 A for 1 s (for full stroke)
Peak electrical power consumption*	1,8 W for 1 s (for full stroke)
Continuous current (for holding after peak)*	1,1 A
Continuous electrical power consumption*	0,6 W

Control using continuous current

Continuous electrical current*	1,2 A
Continuous electrical power consumption*	0,7 W
Opening time*	5 s (for full stroke)

* Data at 20 °C

Please note:

- The actuators are current-controlled. For easy integration and evaluation we offer electronic control units.
- An electrical overcurrent may reduce cycle life-time.
- We recommend validating the current profiles within your specific application and ambient conditions.
- Do not attempt to operate the actuator at constant voltage!



BMT Fluid Control Solutions GmbH
Max-Planck-Straße 16 – D-61381 Friedrichsdorf
Tel.: +49 6101 95400-30 – Fax: +49 6101 95400-39

info@pumpen-ventile.de – www.pumpen-ventile.de

Technische Änderungen Vorbehalten

2023-08

Examples for other peak electrical currents

Peak current	Full stroke time	Peak power
1,5 A	2,0 s	1,1 W
2,0 A	0,8 s	2,0 W
2,5 A	0,3 s	3,1 W

NC force (passive)

Position/stroke	NC force (no power applied)
0,5 mm	0,5 N
1,0 mm	0,8 N
1,5 mm	1,2 N

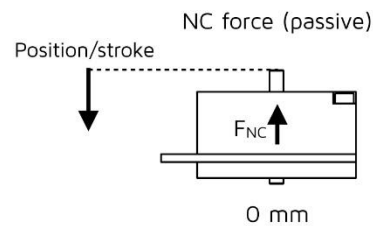

Push/pull force (power applied)

Position/stroke	Push/pull force (power on)
0,0 mm	3,5 N
1,0 mm	1,7 N
1,5 mm	0,7 N

Power ON →

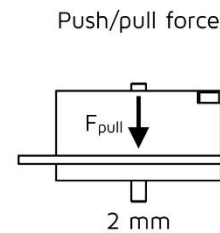

BMT Fluid Control Solutions GmbH
 Max-Planck-Straße 16 – D-61381 Friedrichsdorf
 Tel.: +49 6101 95400-30 – Fax: +49 6101 95400-39

info@pumpen-ventile.de – www.pumpen-ventile.de

Technische Änderungen Vorbehalten

2023-08